

## TUFFSQUARE<sup>®</sup> USER GUIDE

- ✓ TuffSquares are strapped together and stacked sixteen high or less on pallets for shipment. While unloading and moving, keep low to ground and move slowly.
- ✓ Level and pack substrate. If a liner or leak detection pad is used, place it under the TuffSquares.
- ✓ Connecting - use a 9/16 in. socket and wrench or impact driver. Bolt together using hardware provided. Tighten bolts 3-5 ft. lbs. (snug). Turn connectors outward to attach to each other or stake to ground. Turn connectors inward for flush finish.
- ✓ Stacking - Special order 10" bolt required. Stack parts with cones facing each other and flat surface facing outward. Slide connector into place, finger tighten bolt from above. Use connector through hole on top and threaded hole on bottom. Assemble next stack and slide into place. Once all TuffSquares are in place, tighten bolts 3-5 ft. lbs. (snug). Do not bend metal or crush plastic.
- ✓ TuffSquares are 36"x 36"x 5"
- ✓ Custom strengths and colors available. Please verify PSI needed for your project.

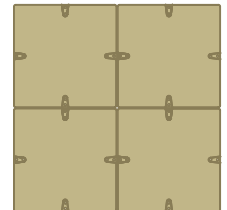
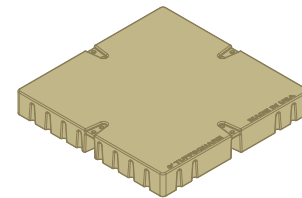

### LOAD CAPACITY

- 3' Standard TuffSquares  
Tan. Max: 22 PSI or 28,512 lbs
- 3' HD TuffSquares  
Grey. Max: 60 PSI or 77,760 lbs
- 3' Super HD TuffSquare  
White. Custom PSI

### CONTACT US

- 🌐 [www.tuffbase.com](http://www.tuffbase.com)
- ☎ 405-542-3069
- 📘 @MurrayServices,Inc.
- 📷 @murrayservicesinc
- 📺 @murrayservicesinc.